



PrecisionGroup





PRECISION GROUP OVERVIEW

Precision is a leading designer
and manufacturer of injection-
molded plastics and tooling

- Engineering Design
- Prototyping
- Custom CNC Machining
- Expert Mold Manufacturing
- Plastic Injection Molding
- Certified Class 8 Clean Room
- Turnkey Contract Manufacturing
- Light Assembly & Packaging



HQ CONTACT INFO

Naum Royberg
Chairman
Tooling & Engineering

nroyberg@pmtool.com
(210) 525-0094 x112

Precision Group
315 North Park Drive
San Antonio, Tx 78216

Domingo Auces
Vice President of Operations
Molding & Tooling Division

dhauces@pmtool.com
(210) 525-0094 x110

Precision Group
315 North Park Drive
San Antonio, Tx 78216

Mold Delivery & Pick Up
Services:

Max Mold Weight
21,000 lbs

Trailer: 20 Foot Long
Gooseneck

Truck: Flat Bed Diesel

Insured & Bonded



LOCATIONS IN USA & MEXICO: PRECISION-GROUP.COM

[WHAT WE DO >](#)[WHO WE SERVE >](#)[GET TO KNOW US >](#)[WORK WITH US >](#)[NEWS](#)[PG 3D EXPERIENCE](#)[CONTACT](#)[English](#)

We offer services to the United States, México and Latin America from our 4 locations:

We are a network of solutions.

San Antonio
TX, USA

Monterrey
NL, MX

La Feria,
TX, USA

Reynosa
TMPS, MX





PRECISION FACILITIES



San Antonio, TX

- 22,000 sq. ft manufacturing facility
- Certified Clean Room Molding & Assembly Class 8
- 6 All Electric Cincinnati Milacron injection molding presses (50-610 tons)
- In-House Machining & Tool & Die Repair Services
- Mold Preventive Maintenance Programs
- 10 Ton Crane & Mold Flipper for handling large molds.
- Unigraphics CAD/CAM Engineering Support
- Makino 3 Axis High Speed CNC Milling
- YCM 5 Axis CNC Milling: Model TCV3000A-5AF
- Yougar YGS-43Z Small Hole Drilling Edm
- Mitsubishi MV2400R Wire Edm
- Mold Transportation up to 30,000 lbs.



PRECISION FACILITIES

La Feria, TX

- 10,000 sq ft manufacturing located ten minutes from Reynosa / Matamoros border
- Climate Controlled Facility.
- Approximately 16 employees.
- Complete tool room 10 mold makers.
- Unigraphics 3D Cad/Cam Engineering
- Mold Transportation

Reynosa, Mexico

- 12,000 sq. ft manufacturing in Reynosa, Tamaulipas, Mexico.
- Complete Tool & Die Repair Facility
- Approximately 10 Tool & Die Makers.
- 24 Hour Tooling Repair Support
- Engineering Modifications
- Onsite Repair Service Available
- Mold Transportation



PRECISION CUSTOMERS

3M

**BLACK+
DECKER**

///TW



Baker Hughes

 **TOYOTA**

Smith+Nephew

artcobell

 **KONGSBERG
AUTOMOTIVE**

COBHAM

OCEANEERING

Teleflex

BOURNS

 **TAKATA**

Alcon

OMRON



CERTIFICATIONS



ISO9001:2015

Manufacture of Molded Plastic Components for Medical, Automotive, Electronic, and Consumer Devices



CERTIFICATIONS



ISO13485:2016

Manufacture of Molded
Plastic Components for
Medical Devices



CERTIFICATIONS



Successfully met WBENC's standards as a women's business enterprise (WBE)

WBENC

WOMEN'S BUSINESS ENTERPRISE
NATIONAL COUNCIL

JOIN FORCES. SUCCEED TOGETHER.

hereby grants

National Women's Business Enterprise Certification

to

ROYBERG INC DBA Precision Mold & Tool Group

who has successfully met WBENC's standards as a Women's Business Enterprise (WBE).
This certification affirms the business is woman-owned, operated and controlled; and is valid through the date herein.

WBENC National WBE Certification was processed and validated by
Women's Business Enterprise Alliance, a WBENC Regional Partner Organization.

Certification Granted: September 11, 2015

Expiration Date: September 11, 2020

WBENC National Certification Number: 2005127447

April Day
Authorized by April Day, President
Women's Business Enterprise Alliance



NAICS: 333511, 326199

UNSPSC: 23151514, 23242400, 23242403, 31141500, 31141501, 31390000, 73180000, 73181000





PrecisionGroup



INTRODUCING
CLEAN ROOM
ISO CLASS 8 CERTIFIED



**HIGH END
MANUFACTURING
FOR MEDICAL
AND SCIENCE APPLICATIONS**



+52 (210) 525-0094

► www.precision-group.com



PrecisionGroup

Expertly crafted
solutions in mold
design, manufacturing
and repair.

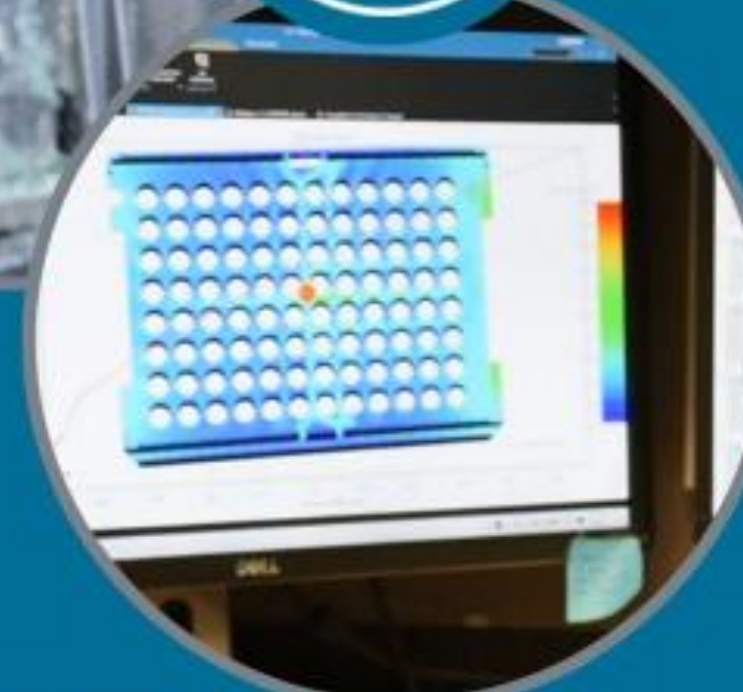

- ✓ Engineering and specialized CAM/CAD design
- ✓ Engineering Changes and Reverse Engineering
- ✓ Plastic Injection Mold Manufacturing
- ✓ Prototyping
- ✓ Mold Repair and Complex Geometry Machining
- ✓ Laser Welding
- ✓ Plastic Injection Molding

+1 210 525-0094
www.precision-group.com



SCIENCE & TECHNOLOGY INDUSTRY

The science & tech industry depends on speed, quality and reliable products.

Precision has the certifications, facility, equipment, and highly trained staff to meet those needs for science/tech clients looking for injection molded products and custom tool design.





MEDICAL INDUSTRY



The medical industry requires knowing the regulatory and validation landscape.

Precision is uniquely experienced in handling these processes and is certified to manufacture molded plastic components for medical devices. Using new innovations to augment strength & flexibility, Precision aims to increase capability, accuracy, and patient comfort.



AUTOMOTIVE INDUSTRY

The auto industry requires high-quality, reliable, and safe products.

Industry leaders like GM & Toyota rely on Precision's innovative approach for support in design, development, prototyping, and rapid manufacturing of plastic, metal parts, and tools.

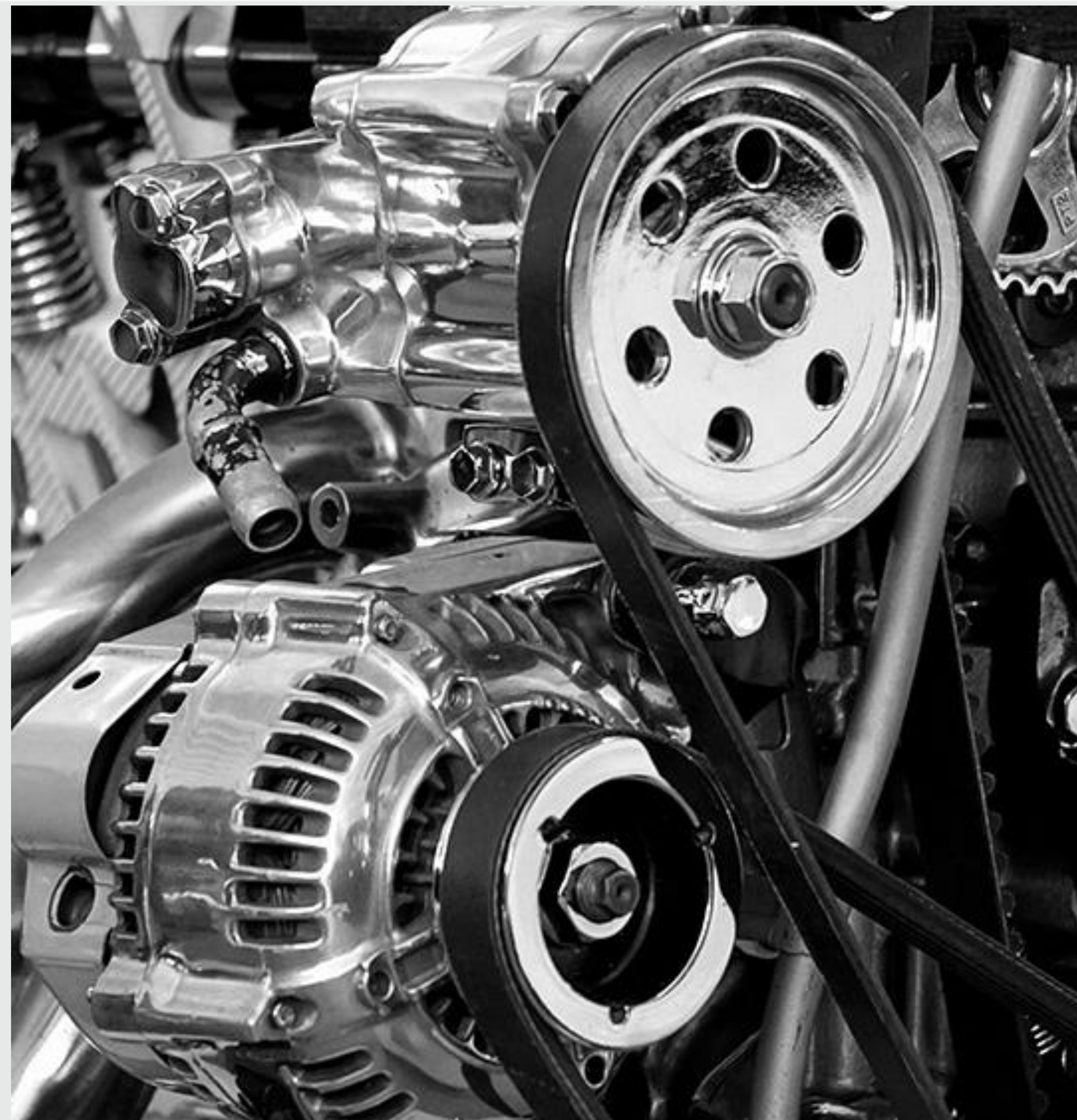



OIL & GAS INDUSTRY



The oil & gas industry expects quick turnaround and superior performance.

Precision produces injection molded parts and custom tool design for industry leaders like Baker Hughes, who relies on high quality and safe products delivered promptly for men and women working in the oil fields.



CONSUMER INDUSTRY

Consumers trust that the products they purchase are reliable and safe.

Precision serves manufacturers of consumer hardware for home appliances & offices, ensuring their products meet those high standards.





ELECTRONICS INDUSTRY



The electronics industry creates critical infrastructure components that enable the communications that we often take for granted.

Precision provides injection molded plastic/metal products and custom tool design for manufacturers of fiber optic and communication device hardware underlying the networks we use daily.



PRECISION MOLDS

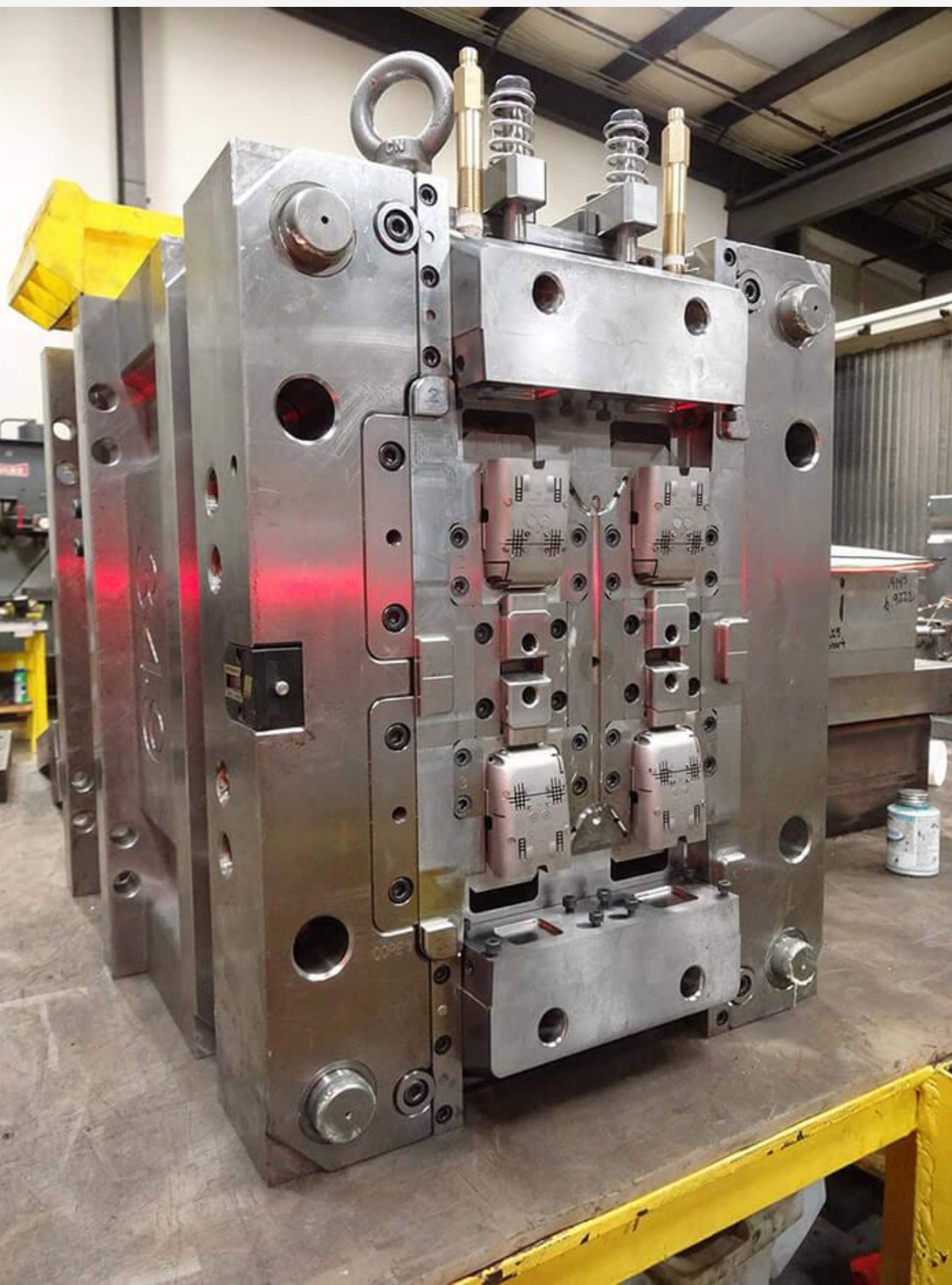



PRECISION MOLDS

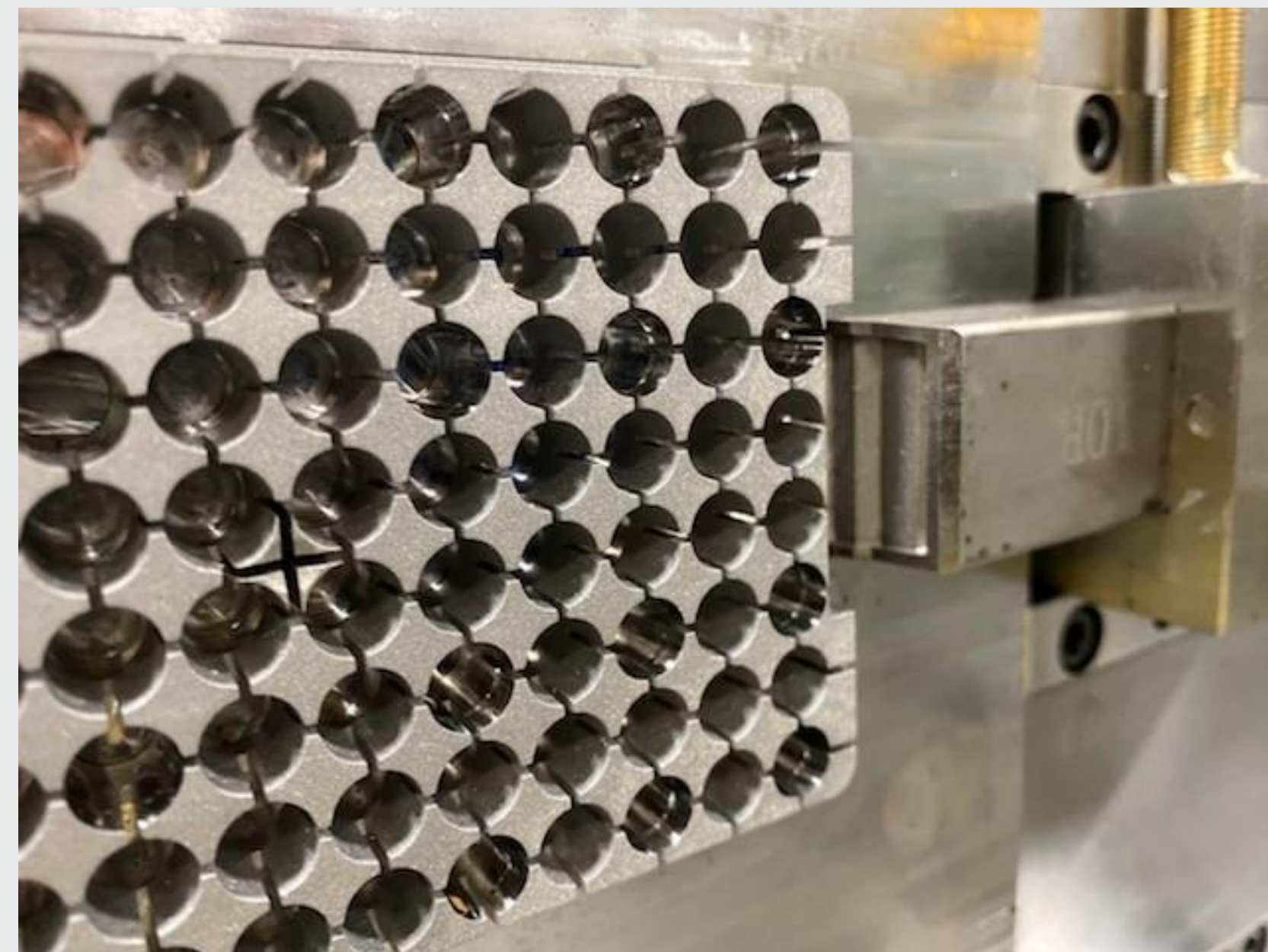



PRECISION MOLDS

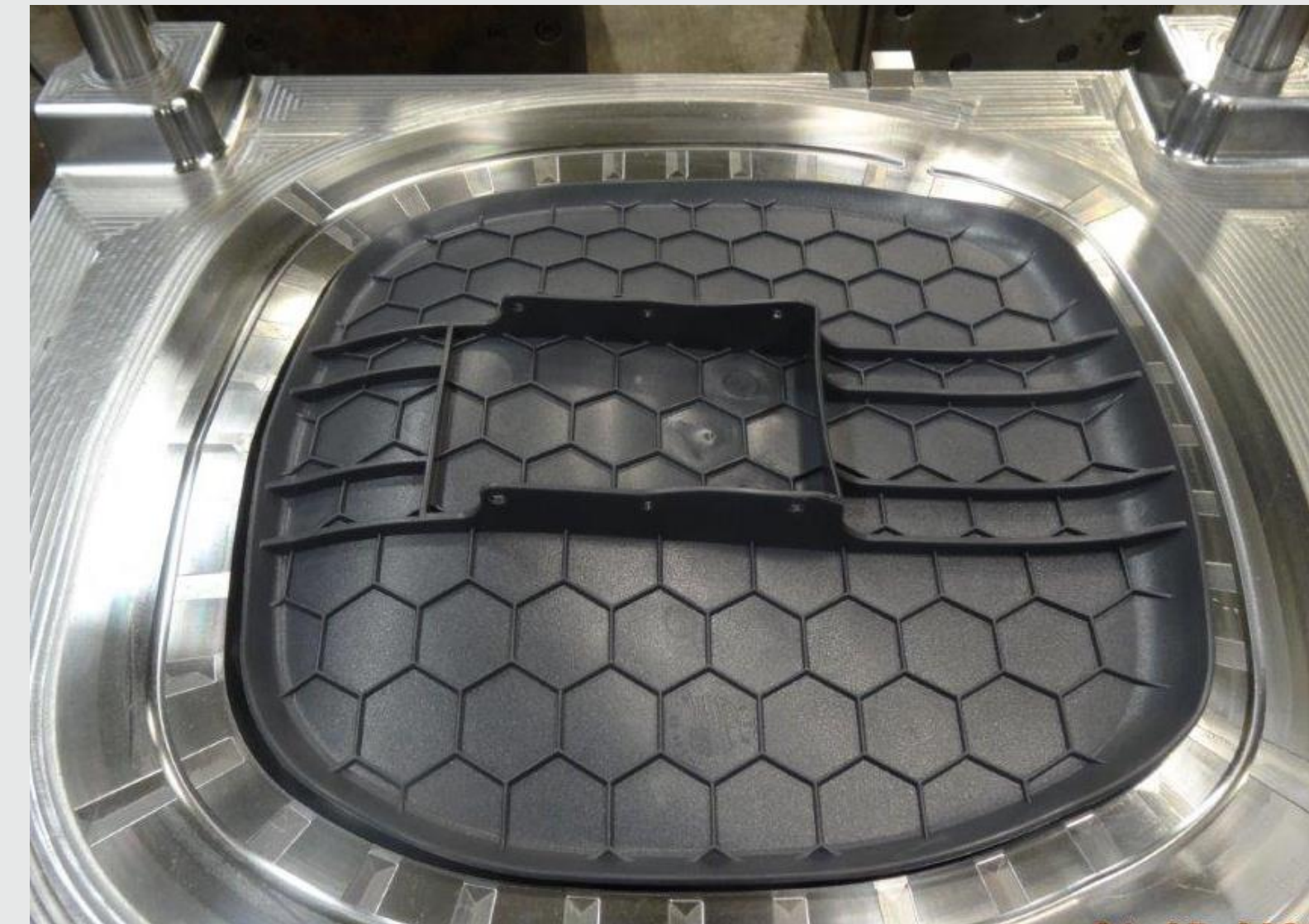
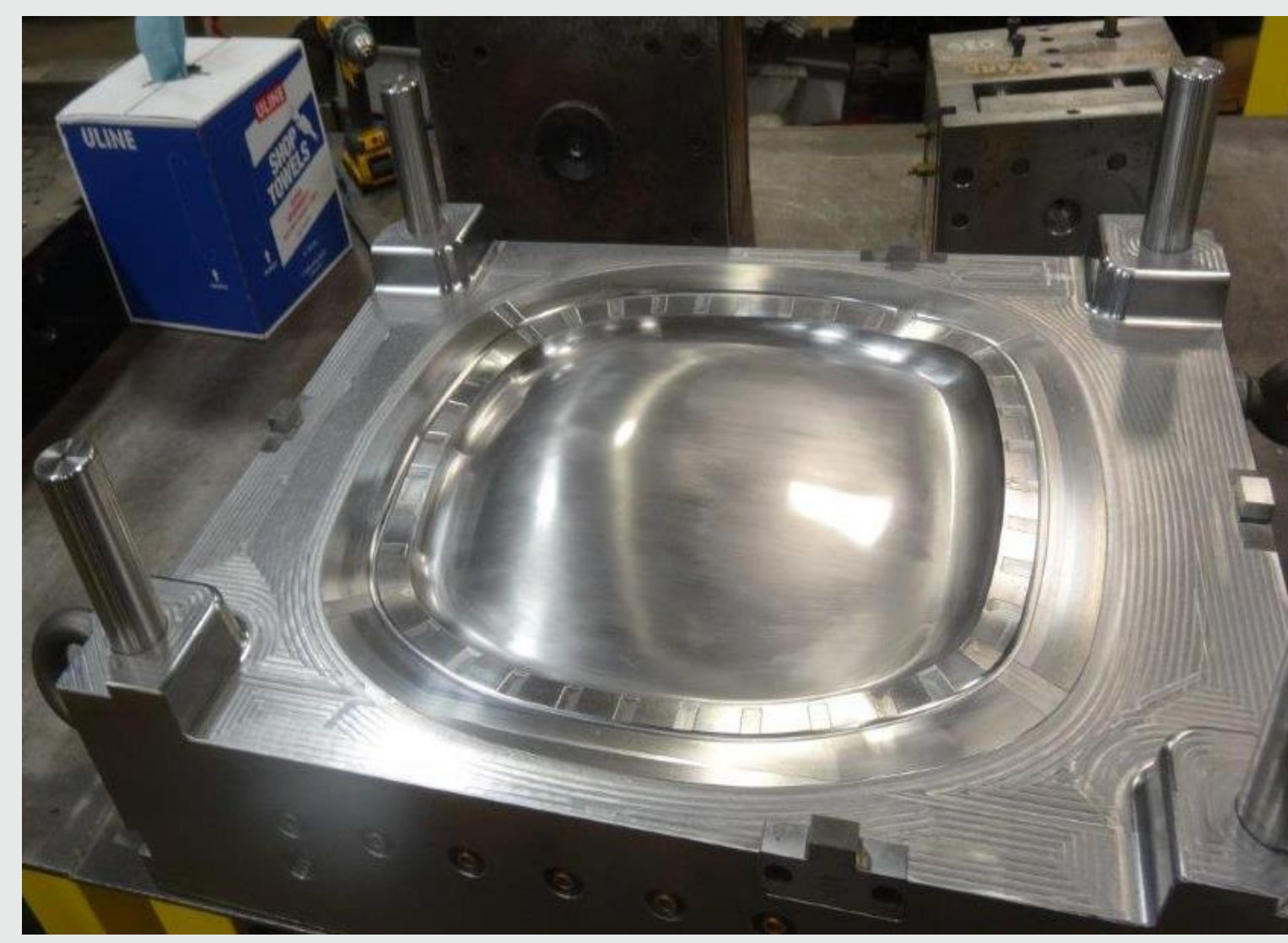
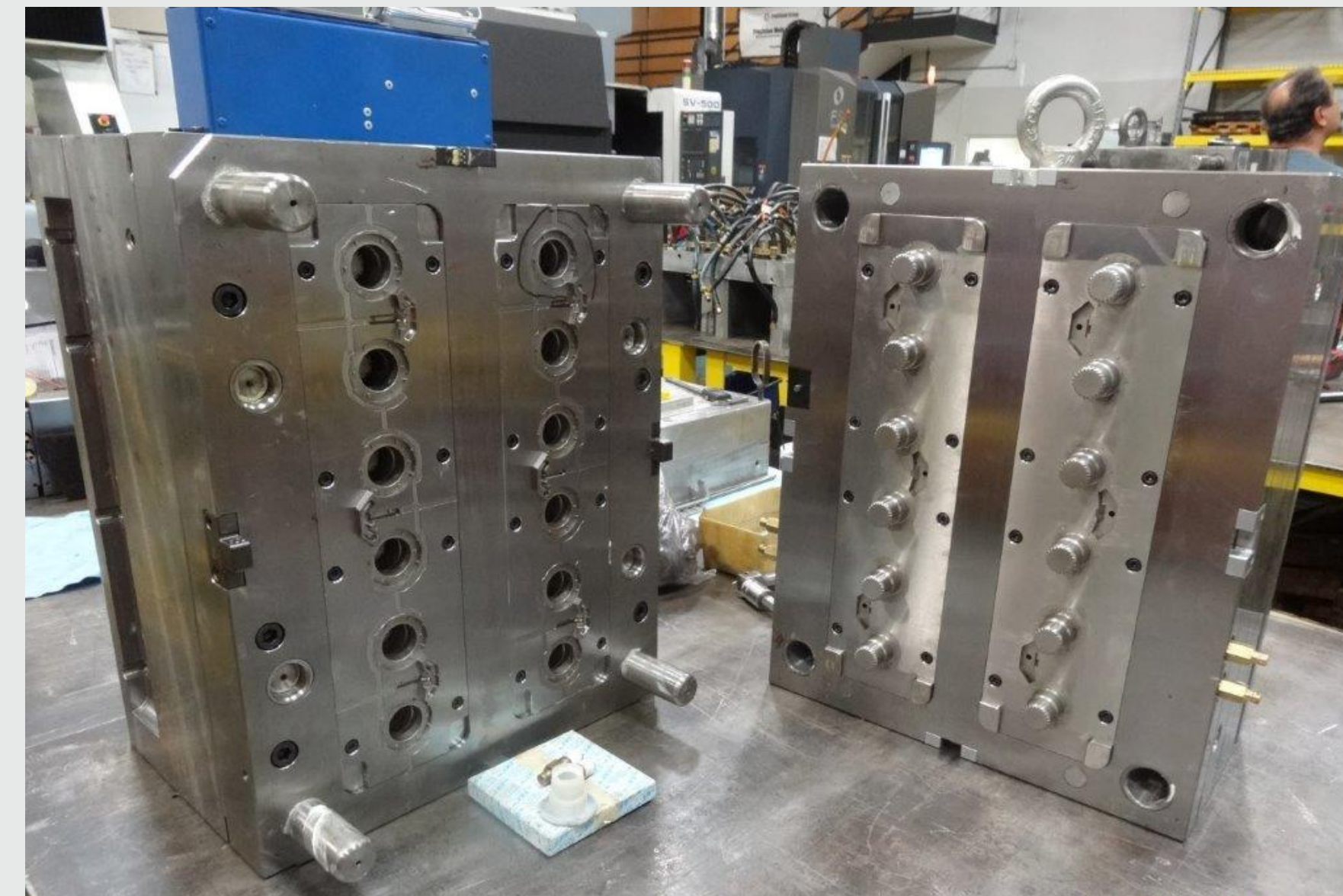



CNC MACHINING





GANTRY EDM LARGE SCALE SINKER



Mitsubishi Gantry 1200 CNC RAM EDM: 15 Postion Auto Tool Changer, Worktank Dimensions 69.7x50x26.8, Table Dimensions 64.5x44.9, Max Workpiece Weight 16,600 lbs, XYZ Travel: 39.3x59x25.6



4 AXIS CNC LATHE MILLING

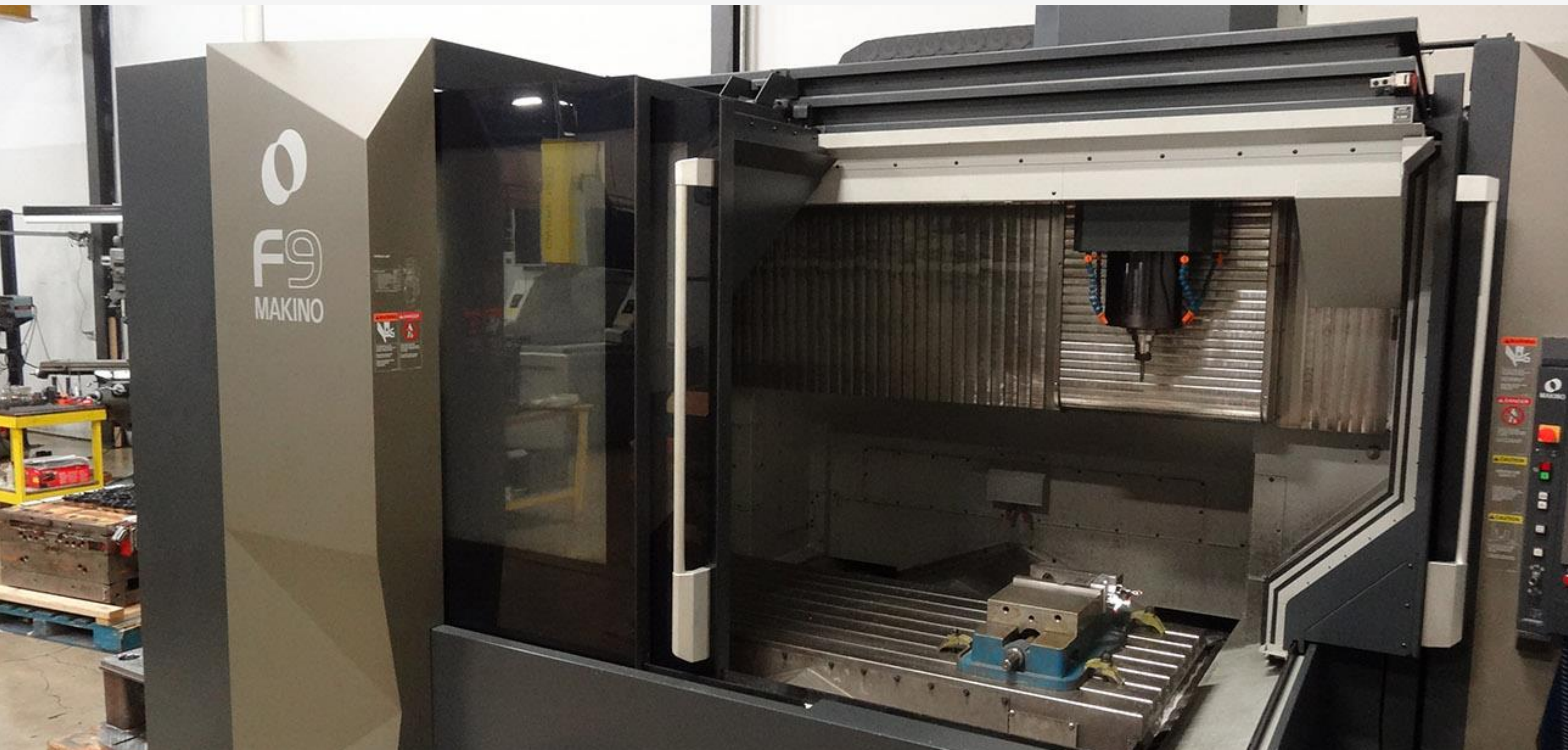



5 AXIS CNC MILLING



5 Axis YCM Conventional CNC Machining Center: TCV3000A-5AF is specially engineered for large work pieces with ultra high feed rate and efficiency. Integrated Rotary Table (C-axis), High Rigidity High Speed X/Y/Z Axial Movement & High Efficiency Traveling Column Design





INJECTION MOLDING DIVISION



Electric Press/Tonnage

- 55 ton Milacron: 55 gr/1.95 oz
- 110 ton Milacron: 97 gr/3.42 oz
- 165 ton Milacron: 300 gr/11 oz
- 280 ton Nissei: 701 gr/23.5 oz
- 390 ton Toshiba: 1063gr/37.5 oz
- 610 ton Toshiba: 1730 gr/61 oz.

Injection Molding Services

- 5 days per week, 1 to 3 eight-hour shifts
- Molding tight tolerance, cosmetic parts, closed loop control, pad printing, ultrasonic welding & contract assembly



MOLDING PRESS SPECIFICATIONS

QTY	MODEL	Tonnage Range	Tie Bar Clearance in.	Injection Capacity (PS)	Max Injection Pressure	Max Barrel Temps	Ejector Stroke	Clamp Stroke	Max Daylight	Min / Max Mold in.	Platen Size in.	Clamp Bolt Size	Capabilities
1	ROBOSHOT 55	28-55	12.6 X 12.6	1.95 oz 55 grams	24,000 ppsi	750° F	2.76 in.	9.84 in.	23.62 in.	5.9 / 13.8	18.1 X 18.1	5/8-11	Hydraulic core unit, Clean Room Class 8
1	ROBOSHOT 110	66-110	16.1 X 16.1	3.42 oz 97 grams	32,000 ppsi	660° F	3.94 in.	13.78 in.	31.50 in.	5.9 / 17.7	24.0 X 24.0	5/8-11	Hydraulic core unit, Clean Room Class 8
1	ROBOSHOT 165	99-165	20.0 X 20.0	10.59 oz 300 grams	26,000 ppsi	660° F	5.12 in.	17.32 in.	36.61 in.	7.8 / 19.3	29.5 X 29.5	5/8-11	Valve gates (1), hydraulic core unit, Clean Room Class 8
1	NISSEI 280	28-280	29.9 X 26.0	23.50 oz 701 grams	22,000 ppsi	750° F	5.91 in.	23.60 in.	53.10 in.	11.8 / 29.5	41.5 X 37.6	M16	Valve gates (2), air blow, hydraulic core unit
1	TOSHIBA 390	198-390	34.2 X 31.9	37.5 oz 1063 grams	20,000 ppsi	750° F	5.90 in.	25.60 in.	52.00 in.	12.6 / 26.3	46.1 X 43.7	3/4-10	Valve gates (1), hydraulic core unit
1	TOSHIBA 610	385-610	37.8 X 35.4	61.0 oz 1730 grams	27,000 ppsi	750° F	7.10 in.	35.40 in.	66.90 in.	15.7 / 31.5	53.7 X 51.2	3/4-10	Valve gates (2), air blow, hydraulic core unit

- Mold sampling, Part Qualification & Validation
- Closed Loop System
- Climate Controlled environment
- Precision Close-Tolerance Production Molding
- Scientific Molding: robust process Development - IQ, OQ, PQ

- ISO standard quality-controlled parts inspection: PPAP, FAI, & SPC, CPK
- Certified Class 8 Clean Room Molding & Assembly
- Pad Printing, Sonic Welding, Leak Testing & Automated Glue Bot



CAD/CAM DESIGN MOLD & MANUFACTURING

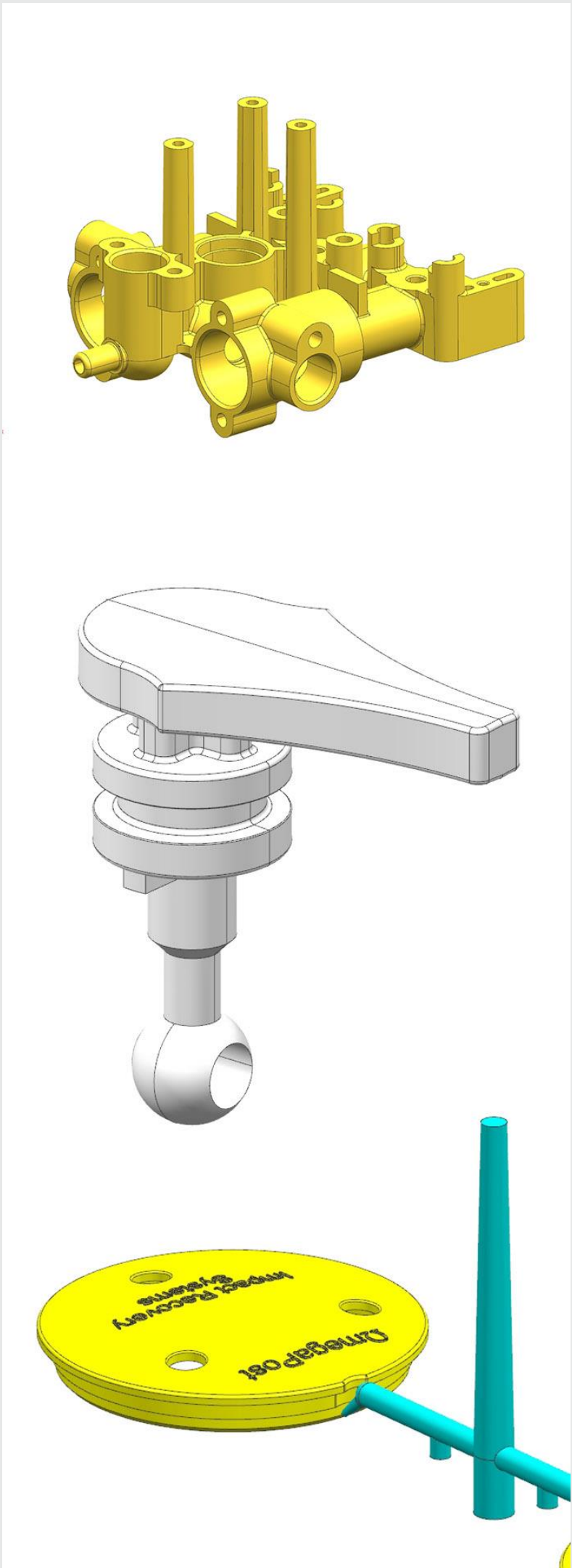
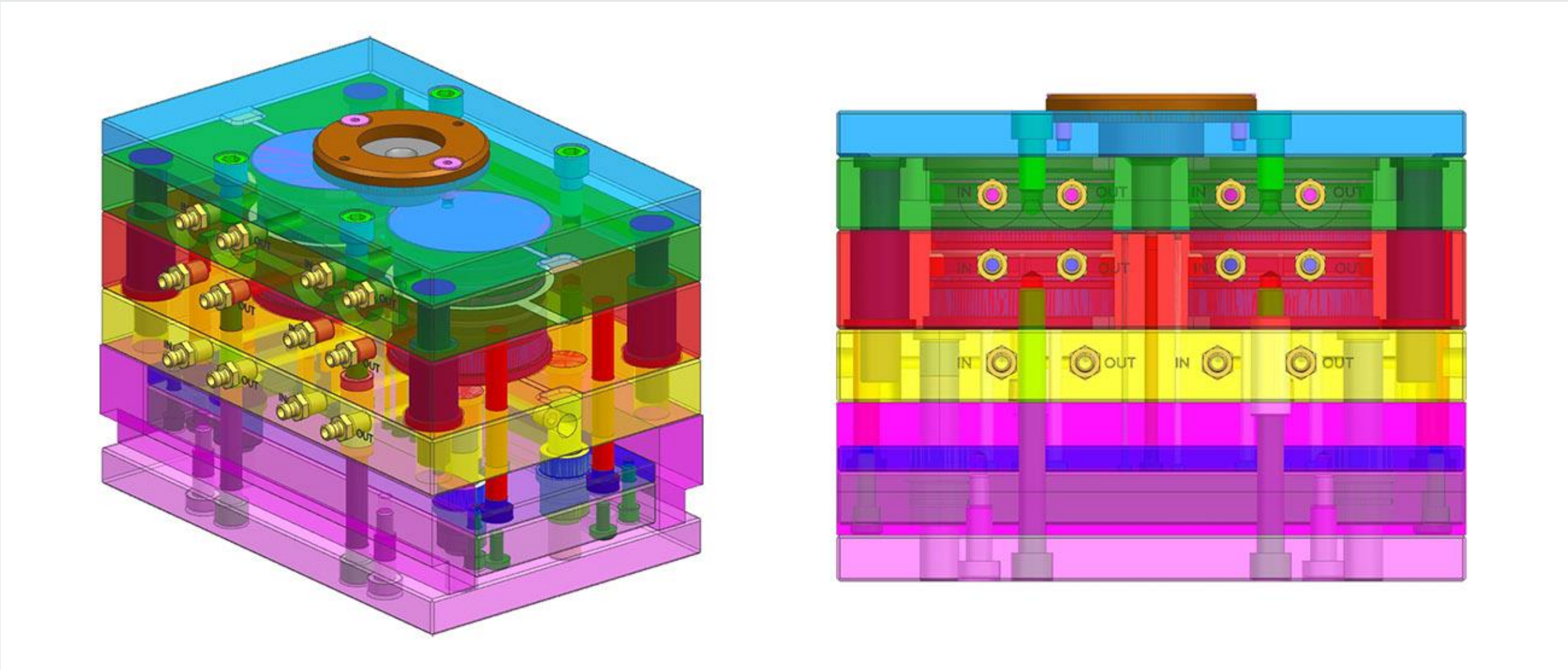
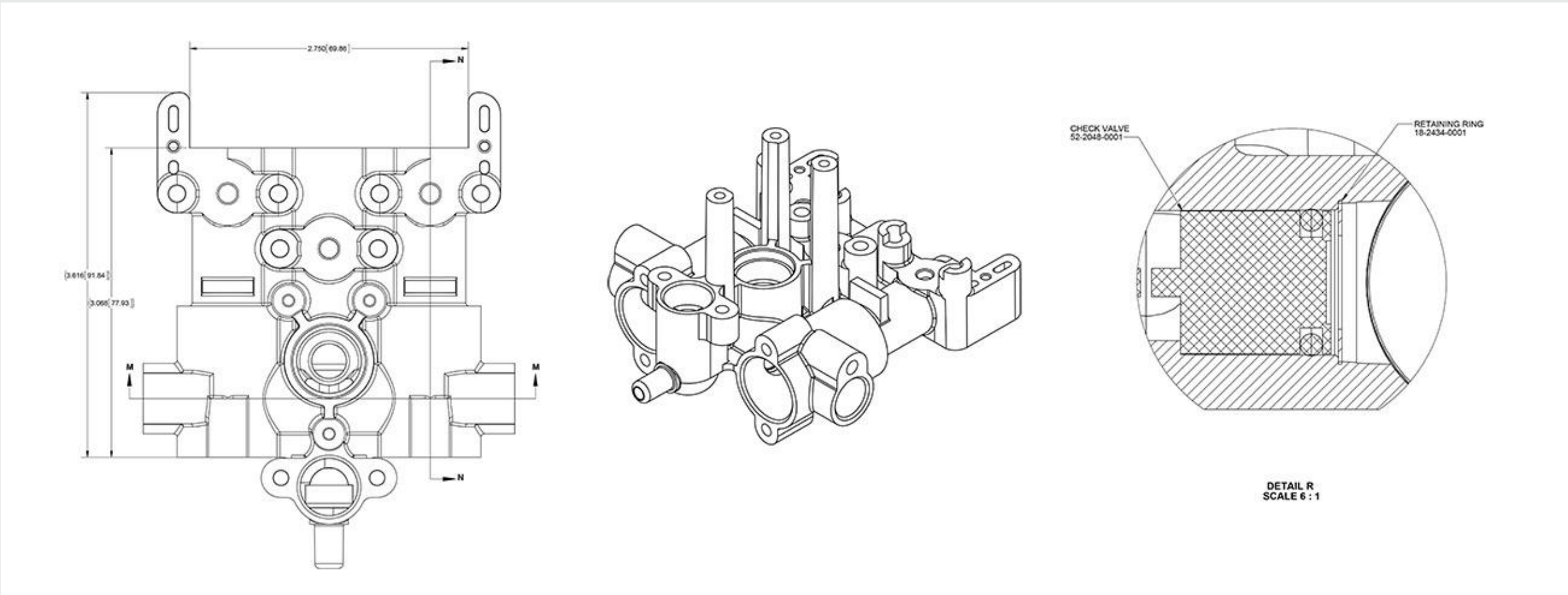
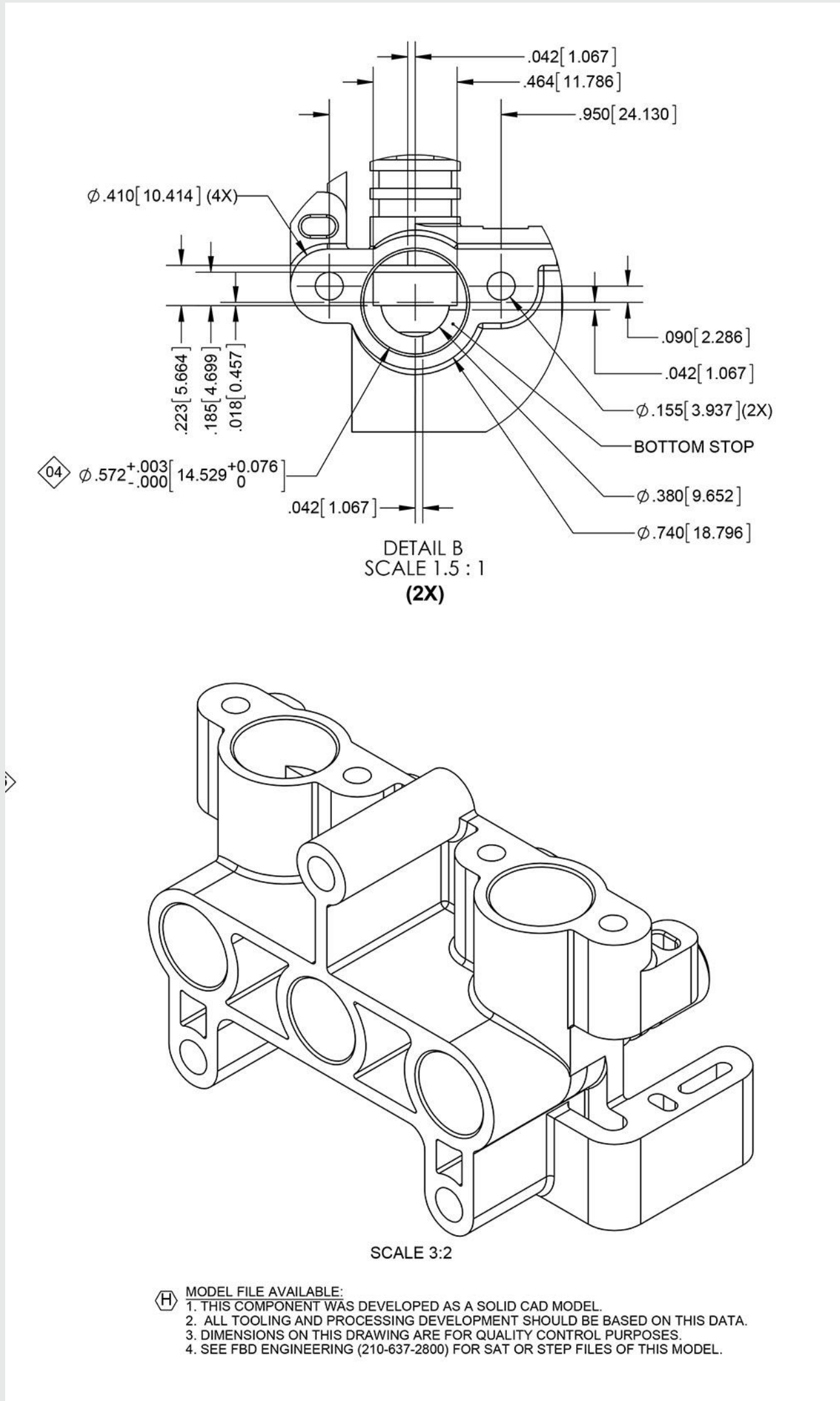



CAD/CAM DESIGN MOLD & MANUFACTURING

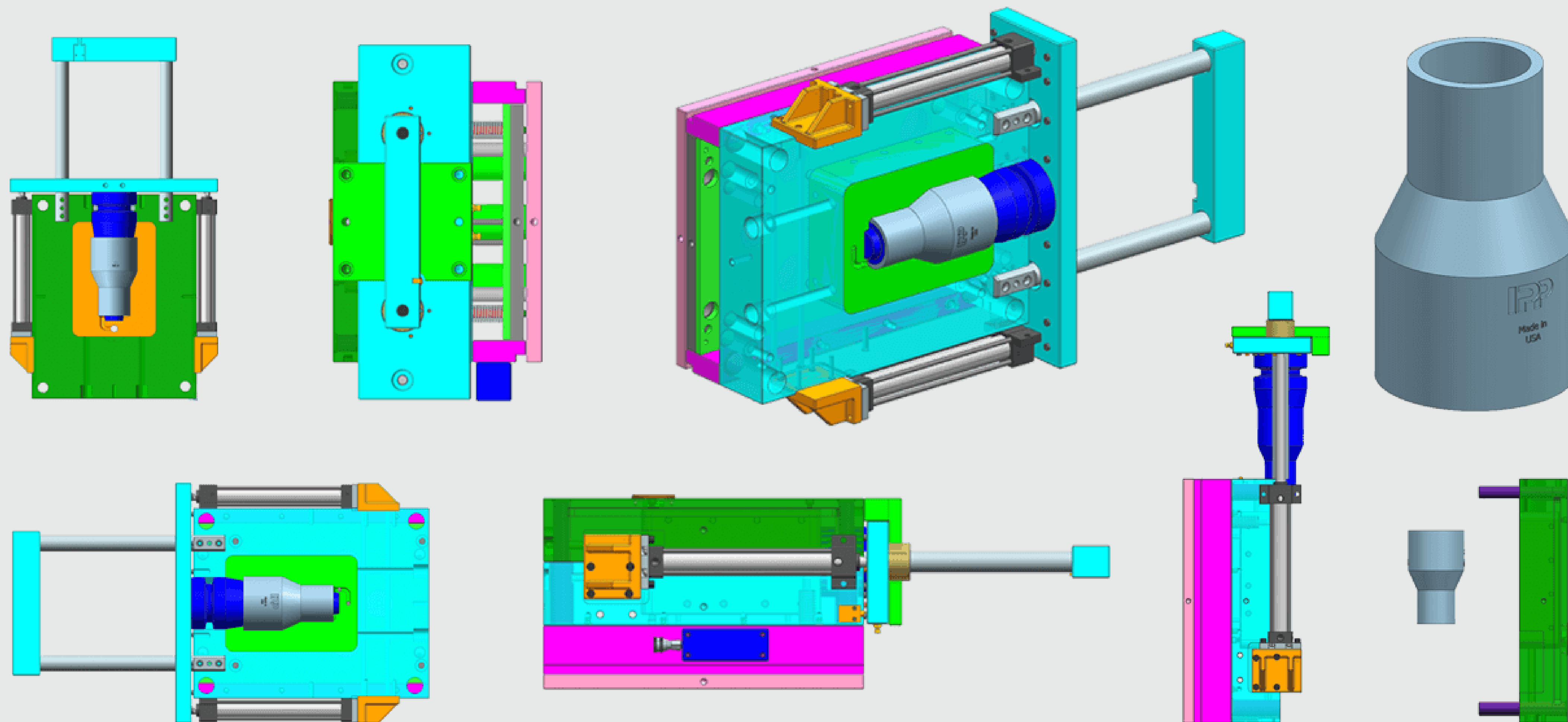



CAD/CAM DESIGN MOLD & MANUFACTURING

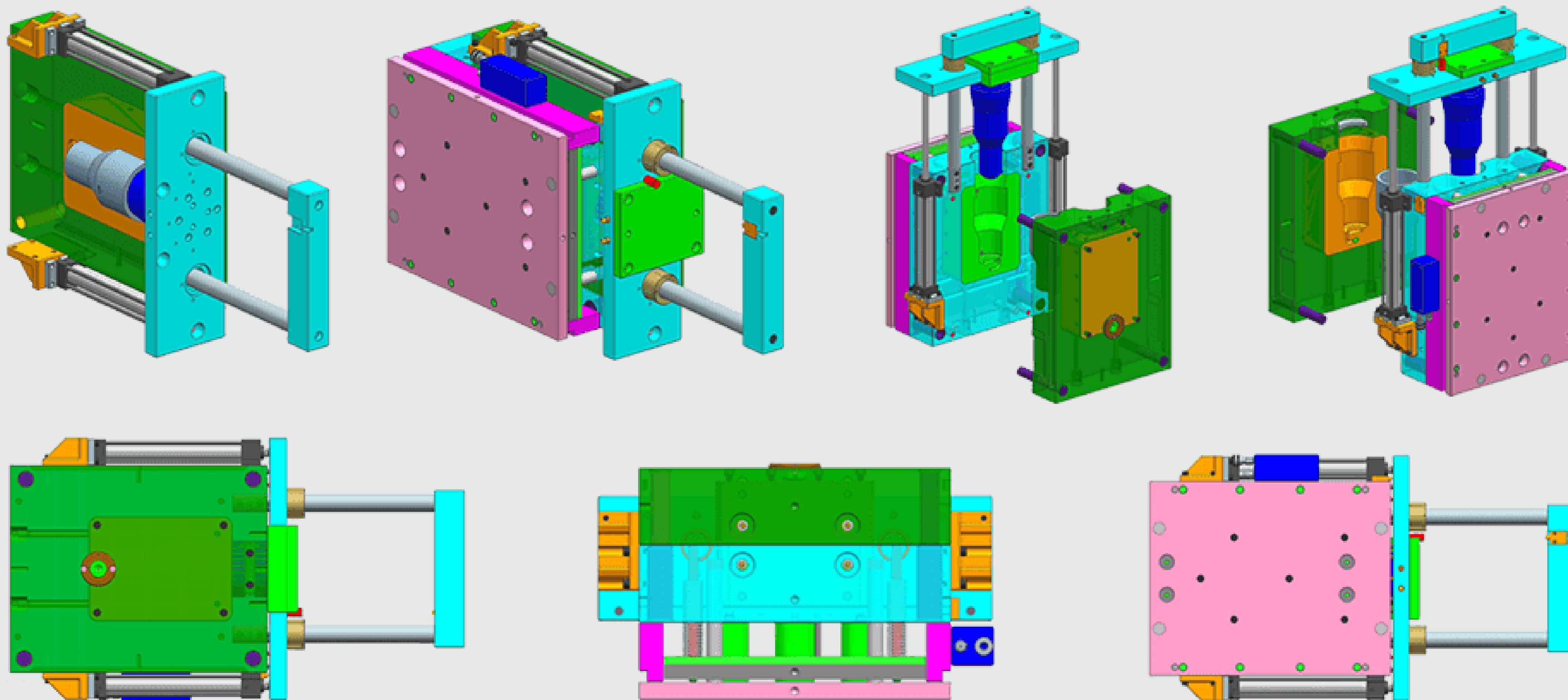



CAD/CAM DESIGN MOLD & MANUFACTURING

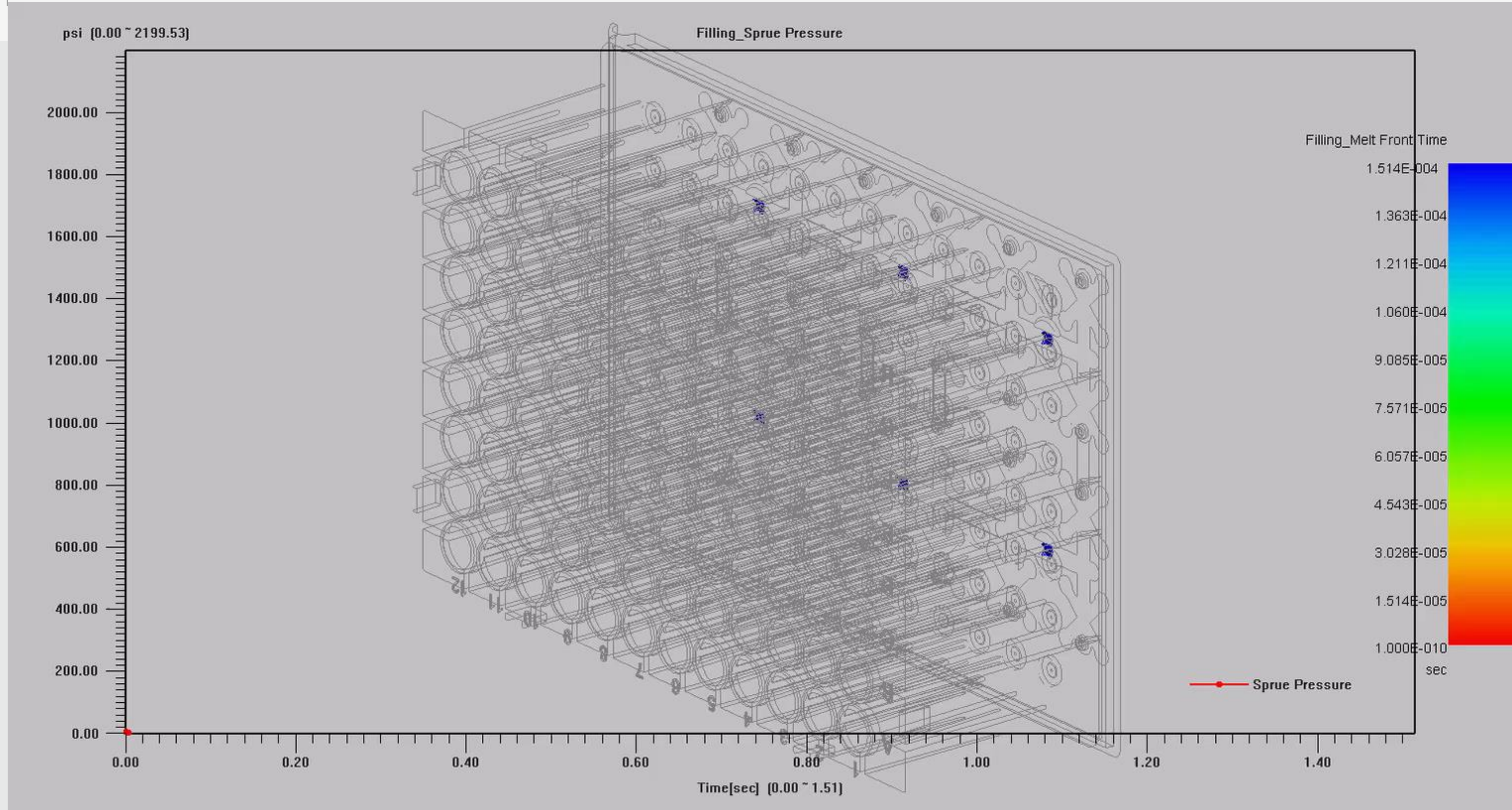



METROLOGY LAB

